

GROUND FLOOR  
APPROX. FLOOR AREA  
680 SQ.FT.  
(63.19 SQ.M.)

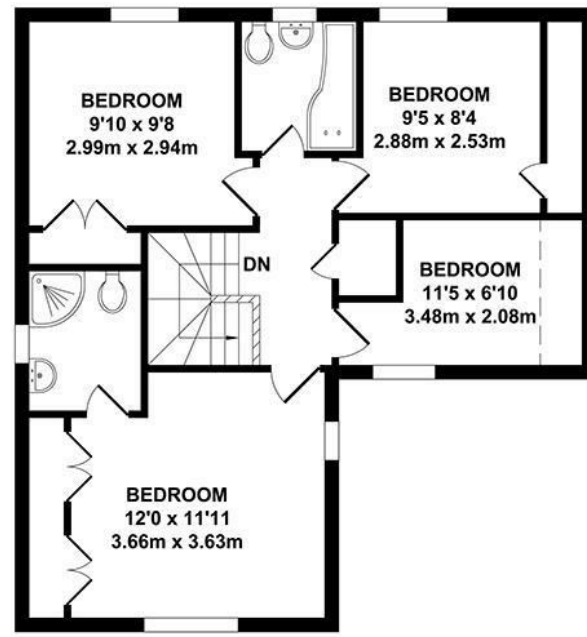

FIRST FLOOR  
APPROX. FLOOR AREA  
584 SQ.FT.  
(54.23 SQ.M.)

TOTAL APPROX. FLOOR AREA 1264 SQ.FT. (117.42 SQ.M.)

Whilst every attempt has been made to ensure the accuracy of the floor plan contained here, measurements of doors, windows, rooms and any other items are approximate and no responsibility is taken for any error, omission or mis-statement. This plan is for illustrative purposes only and should be used as such by any prospective purchaser. The services, systems and appliances shown have not been tested and no guarantee as to their operability or efficiency can be given.  
Zome Media ©2025



01732 522 822  
info@khp.me



Lapins Lane  
Kings Hill ME19 4LA  
Offers Over £625,000

Tenure: Freehold

Council tax band: F



